



7000 SERIES

STAINLESS STEEL TAILORING SHEARS
FOR PROFESSIONAL USE



fine tools for doing and making things

7000 SERIES

STAINLESS STEEL TAILORING SHEARS
FOR PROFESSIONAL USE.



kai corporation

Tokyo, Japan E-mail : user@kai-group.com
Europe : www.kai-europe.com

GB

- ① Blades made of high-carbon Molybdenum Vanadium stainless steel for extra-long edge life and high cutting efficiency.
- ② Full-length "blade-to-grip" design for optimal cutting balance.
- ③ Novel duplex interlock screw for lasting blade tension.
- ④ Ergonomically styled and padded grip made of "Elastomer" soft plastic for maximum ease of handling.

D

- ① Scherenblätter aus rostfreiem Molybdän-Vanadin-Sonderstahl für höchste Schneiden-Standzeit und Schneidfähigkeit.
- ② Durchgehende "Blatt-Griff" Ausführung für optimale Schneid-Balance.
- ③ Neuartige Doppel-Mutter Justierschraube für bleibende Schneidenspannung.
- ④ Scherenaugen mit "Elastomer" Weichplastik-Griffpolstern für maximalen Schneidkomfort.

F

- ① Les ciseaux sont élaborés à partir d'un alliage inoxydable de métaux de haute qualité qui confère à leur tranchant une longévité exceptionnelle.
- ② Avant d'être recouvertes, les branches métalliques sont élaborées d'une seule pièce donnant à la paire de ciseaux un équilibre parfait.
- ③ Les ciseaux sont dotés d'une nouvelle double fixation à écrous de pivot indévissable lors de la coupe, même pour les travaux difficiles.
- ④ Les anneaux de branche ergonomiques sont recouverts d'un mélange "Elastomer" offrant un grand confort de travail.

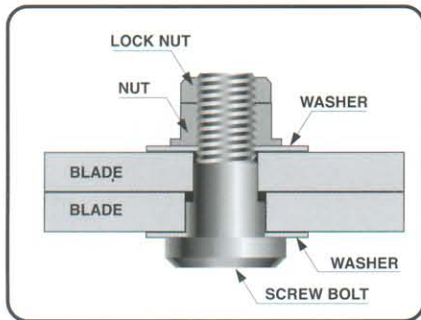

7000 SERIES UNIQUE FASTENER SYSTEM ③

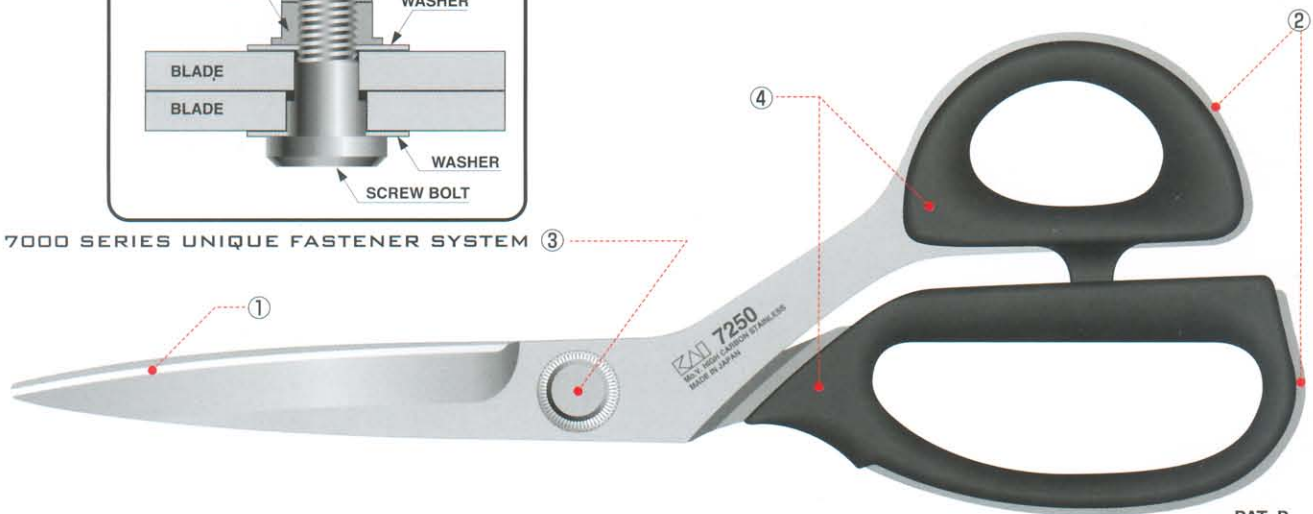

I

- ① Lame in acciaio inox Molibdeno-Vanadio ad alta percentuale di carbonio che garantisce una durata del filo eccezionale ed un'efficienza di taglio superiore.
- ② Manico e lame in un pezzo unico disegnate per un bilanciamento ottimale nel taglio.
- ③ Nuovo perno a doppio dado "Interlock", facilmente regolabile, per una tensione perfetta.
- ④ Manici ergonomici ricoperti da un'imbottitura in "Elastomer": massimo comfort e facilità di impugnatura.

E

- ① Las hojas están hechas de alto contenido carbono molybdenum vanadium acero inoxidable, mientras las tijeras convencionales están fabricadas de carbón-acero no-inoxidable. Esto quiere decir que las tijeras son resistentes contra la corrosión y al desgaste de las hojas.
- ② La hoja llega dentro del mango, haciendo que las tijeras estén bien equilibradas y fuertes.
- ③ El nuevo tornillo doble aguanta las 2 hojas fuertemente durante un tiempo mas largo.
- ④ El mango, protegido por "Elastomer", es muy cómodo en la mano.



A KAI PRODUCT



7300 12"(300mm)



7280SE 11"(280mm)
MICRO SERRATED EDGE

7280 11"(280mm)

7000 SERIES

STAINLESS STEEL TAILORING SHEARS
FOR PROFESSIONAL USE



7250SE 10"(250mm)

MICRO SERRATED EDGE



7250 10"(250mm)



7250SL 10"(250mm)

SLIM & LIGHT



Ultra Wheel Cutter RX-45

Overall Length : 180mm



**Safety Guard Locks Into Position.
45mm Diameter Tungsten Steel Blade.**

- Easier to use than scissors
- Ideal for quilting, sewing, crafts
- Cuts in any direction
- Cuts single or multiple layers of fabric with ease
- Replace worn blades with KAI Replacement Blade

**The Contemporary Double-Injected
Handle Design is Ergonomically Soft-Cushioned
to fit the Hand Perfectly.**



Wave Blade / Pinking Blade / Straight Blade
5045WBL 5045PBL 5045BL



N5000 SERIES



kai original

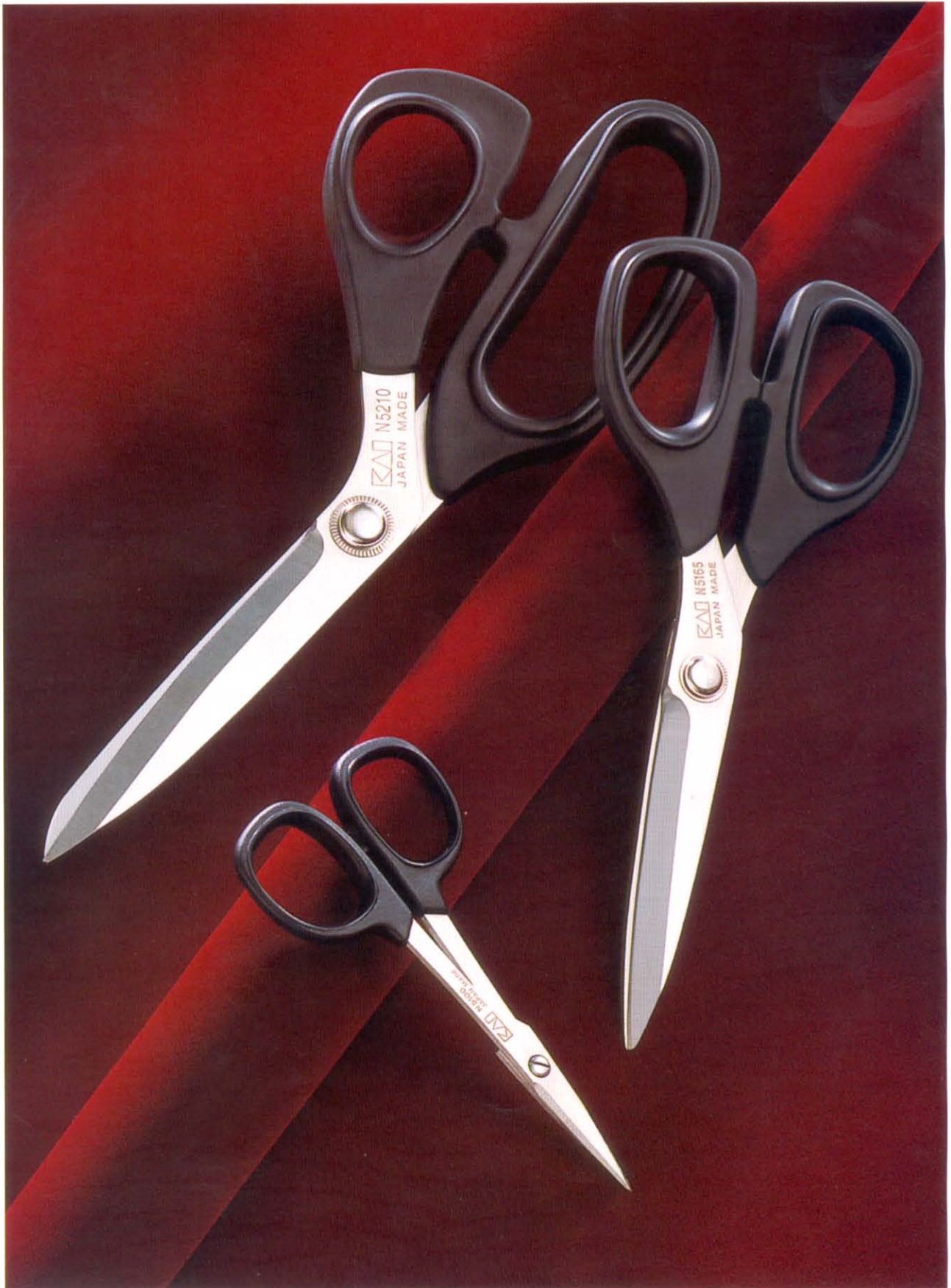

fine tools for doing and making things

8inch/210mm

N5210

DRESSMAKING SHEARS
STOFFSCHERE
CISEAUX DE COUTURIERE
FORBICI PER SARTINA

✓ N5210 SE ✓ N5210 KE



MADE OF FINE STAINLESS STEEL WITH VANADIUM

8 1/2inch/220mm

N5220

✓ N5220C CURVED

DRESSMAKING SHEARS
STOFFSCHERE
CISEAUX DE COUTURIERE
FORBICI PER SARTINA



N5220L LEFT



MADE OF FINE STAINLESS STEEL WITH VANADIUM

6 1/2inch/165mm

N5165

✓ N5165C CURVED ✓ N5165 SE

SEWING SCISSORS
NAHSCHERE
CISEAUX DE COUTURE
FORBICI PER CASA MIS.GRANDE



STRAIGHT



CURVED

MADE OF FINE STAINLESS STEEL WITH VANADIUM

5 1/2inch/135mm

N5135

✓ N5135C CURVED

EMBROIDERY SCISSORS
STICKSCHERE
CISEAUX POUR BRODERIE
FORBICI PER CASA MIS.MEDIA



STRAIGHT



CURVED

MADE OF FINE STAINLESS STEEL WITH VANADIUM

4 inch/100mm

N5100

✓ N5100C CURVED

NEEDLE CRAFT SCISSORS
FEINE STICKSCHERE
CISEAUX POUR TRAVAUX MINUTIEUX
FORBICI PER RICAMO

STRAIGHT

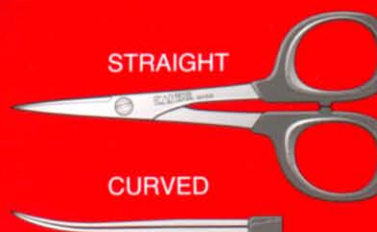

CURVED

MADE OF FINE STAINLESS STEEL WITH VANADIUM



8 inch/210mm
 N5210L LEFT
DRESSMAKING SHEARS
STOFFSCHERE
CISEAUX DE COUTURIERE
FORBICI PER SARTINA

MADE OF FINE STAINLESS STEEL WITH VANADIUM

9 inch/230mm
 N5230

BENT TRIMMER SHEARS
ZUSCHNEIDESCHERE
CISEAUX DE COUTURIERE
FORBICI PER SARTINA

✓ N5230 KE



MADE OF FINE STAINLESS STEEL WITH VANADIUM

10 inch/250mm
 N5250

DRESSMAKING SHEARS
ZUSCHNEIDESCHERE
CISEAUX DE COUTURIERE
FORBICI PER SARTINA

✓ N5250 SE / ✓ N5250 KE



11 inch/275mm
 N5275

✓ N5275 SE / ✓ N5275 KE



MADE OF FINE STAINLESS STEEL WITH VANADIUM

4 1/2 inch/120mm
 N5120

SNIPPITS
THREAD SNIPPERS
RINGFINGERSCHERE
COUPE FILS COURT
RASAFIRO



MADE OF FINE STAINLESS STEEL

8 inch/200mm
N5350

PINKING SHEARS
ZACKENSCHERE
CISEAUX CRANTEURS
FORBICE A ZIG ZAG



COMFORTABLE LIGHT WEIGHT HANDLE MADE OF FINE STAINLESS STEEL

5045

WHEEL CUTTER
ROLLSCHNEIDER
ROULETTE A DECOUPER
CUTTER A ROTELLA



FOR CUTTING CLOTH, LEATHER, VINYL, FILM, PAPER
45mm DIAMETER TUNGSTEN STEEL BLADE

FOR 5045 WHEEL CUTTER



5045BL
STREIGHT BLADE



5045PBL
PINKING BLADE



5045WBL
WAVE BLADE

5028

WHEEL CUTTER
ROLLSCHNEIDER
ROULETTE A DECOUPER
CUTTER A ROTELLA



FOR CUTTING CLOTH, LEATHER, VINYL, FILM, PAPER
28mm DIAMETER TUNGSTEN STEEL BLADE



5028G
GUIDE ARM
FÜHRUNGSARM
GUIDE BRAS
GUIDA



FOR 5028 WHEEL CUTTER
5028BL
STREIGHT BLADE

GUIDE ARM MAKES ADDING SEAM ALLOWANCES EASY
ADJUSTABLE FOR RIGHT OR LEFT HAND USE

CUTTING MAT
SCHNEIDEUNTERLAGE
SUPPORT DE COUPE
TAVOLA PER TAGLIO

CB-143: 600mm×1430mm
CB-1 : 600mm×900mm
CB-2 : 450mm×600mm
CB-3 : 150mm×460mm

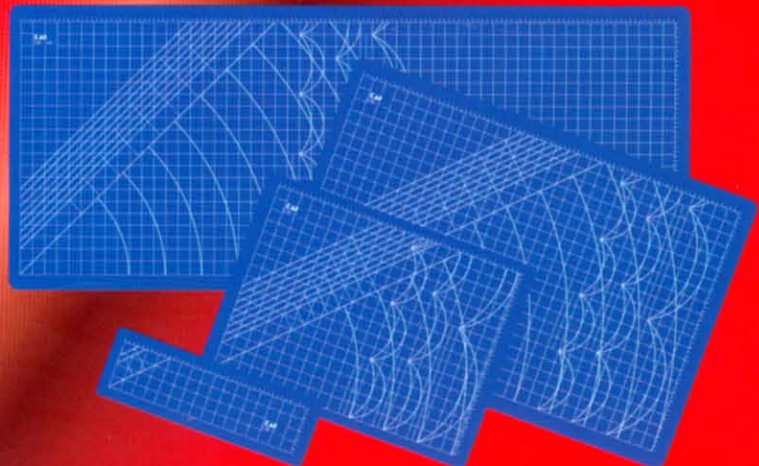

SELF HEALING, BOTH -SIDES USE
THICKNESS 1.5mm